

SECTION 1

SCALE 1:50

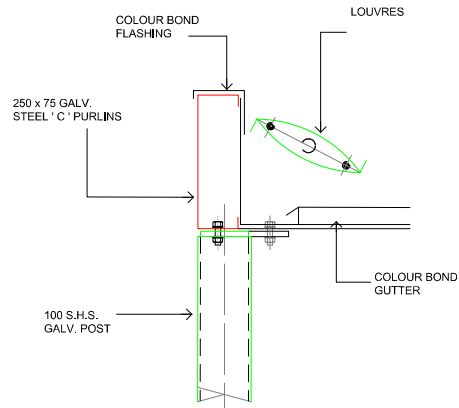

POST DETAIL

SCALE 1:10

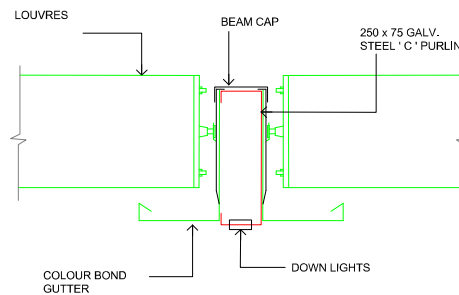

CENTRE BEAM DETAIL

SCALE 1:10

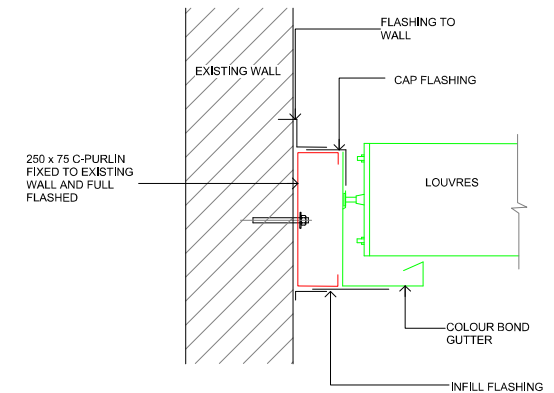

FIXING DETAIL

SCALE 1:10

LEGEND:

- METAL-STEEL FRAME/ "VERGOLA" - PAINTED -
- METAL DOWNPIPE/ GUTTERS - PAINTED

GENERAL NOTES

All work to be carried out in accordance with the Building Code of Australia, all Local and State Government Ordinances, relevant Australian Standards, Local Electricity and Water Authorities Regulations and all other relevant Authorities concerned.

All timbers to be in accordance with SAA Timber Structure Code AS1720 and SAA Timber Framing Code AS 1684.

All work to be carried out in a professional and workmanshiplike manner according to the plans and specification.

Do not scale off the drawings unless otherwise stated and use figured dimensions in preference.

All dimensions are to be checked and verified on site before the commencement of any work.

Locate and protect all services prior to construction.



7 TEPKO ROAD TERREY HILLS NSW 2084
TEL: (02) 9450 3300
FAX: (02) 9450 3333

Project:

PROPOSED VERGOLA LOUVERED ROOF SYSTEM AT EXISTING UNITBLOCK

Client:

ZAC REES

Address:

**UNIT 51, 4 CHARLES STREET
CANTERBURY - NSW - 2193**

DATE DRAFTED 01-02-22	AMENDED DATE A -
SALES REP. B.P	B -
DRAWN JGW	C -
DRAWING No. 19031	SHEET No. 3 OF 6
SCALE AS NOTED @A3	DATE SIGNED
CLIENTS SIGNATURE	

**ALL MEASUREMENTS TO
BE VERIFIED AT C/M**